

EXAMPLE

CITY OF SANDUSKY FOOTER DETAIL REQUIREMENTS

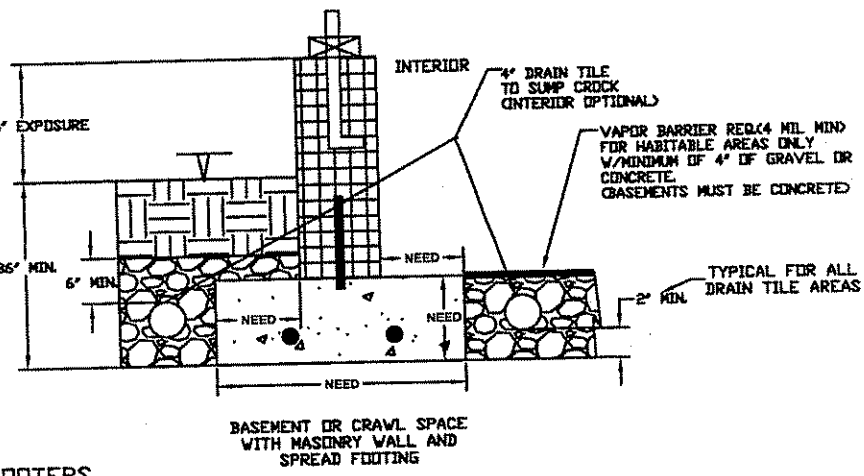

SPREAD FOOTERS
 IF LATERAL REINFORCEMENT
 REQUIRED,
 DRAWING WILL BE NEEDED.

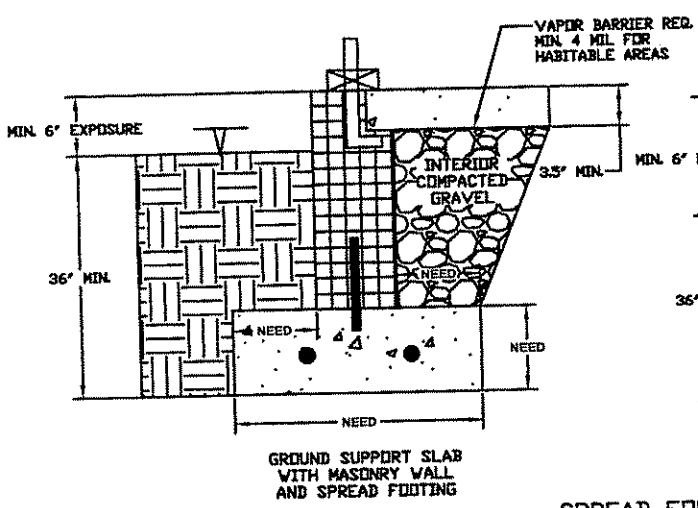
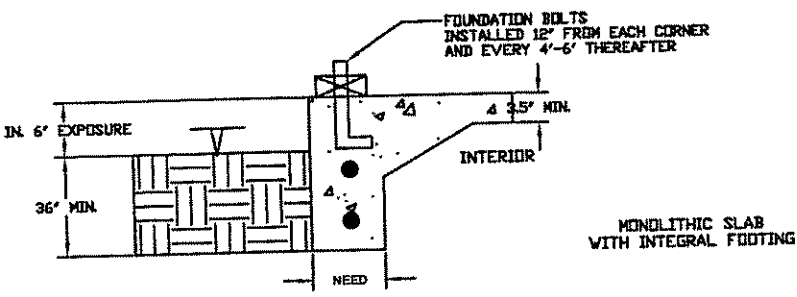
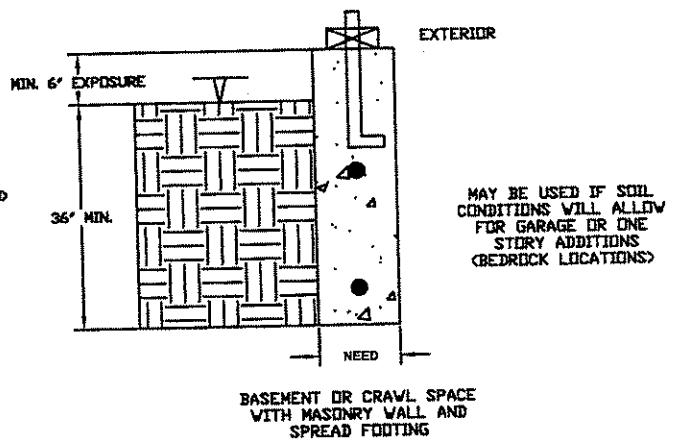
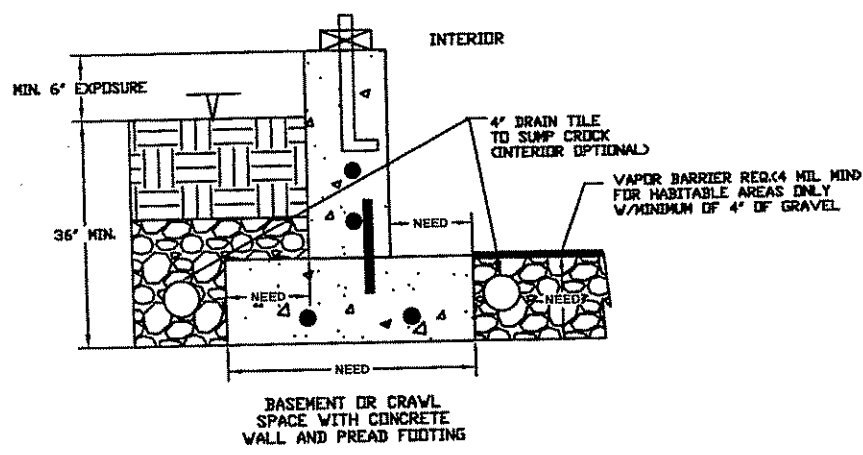

NOTES:

1. REBAR TO BE PLACED ACCORDINGLY. (MIN. #4 = 1/2") VERTICAL REBAR SHOULD BE PLACED SAME AS FOUNDATION BOLTS.
2. HORIZONTAL REBAR IN CONCRETE WALLS SHOULD BE PLACED 16" OR 18" ON CENTER.
3. CONCRETE WALLS MUST BE PINNED TO FOOTER OR HAVE A GROVE IN FOOTER TO INTERLOCK W/MORTAR AS BLOCK IS LAYED.
4. MUST HAVE 6' MIN. TO BOTTOM OF